



# Installation instructions

## MINOROC®

### Aluminium termination



The termination is slid into the rope.

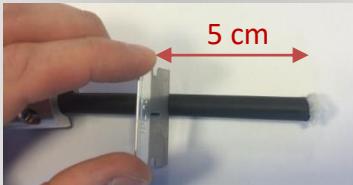

At the end of the rope a circumferential cut is made around the rope sheath (at 5 cm). Care must be taken to avoid cutting through the core fibers (very important!). Finish removing the sheath by folding the cable repeatedly.



Remove the cut part of the sheath

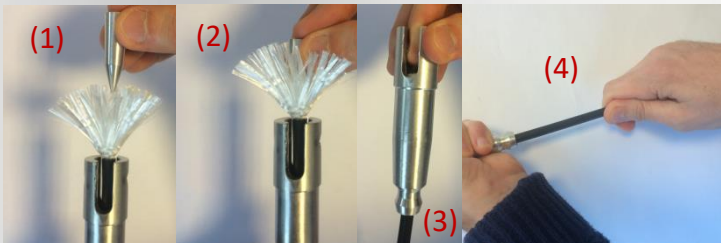

In vertical position, fibers are positioned around the termination (in a uniform way) ( 1 ). Place the spike in the center of fibers ( 2 ) then pull downwards the cable to put back the spike in the cable ( 3 ). Once connected, pulled repeatedly to exercise a first tension to the cable ( 4 ).

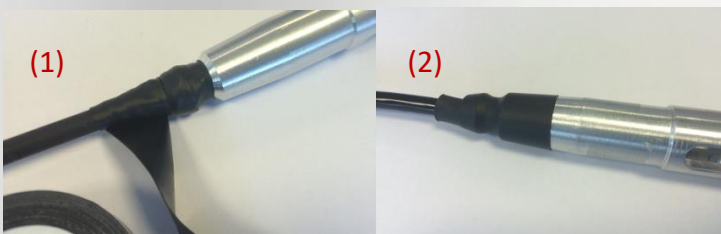

You have two solutions to have a better waterproofness of the system (in the junction between the cable and the termination) :

- ( 1 ) use a self-amalgamating tape
- ( 2 ) use a heat-shrinkable tube

Finally at the base of the spike, you can also use some silicone sealant.