

FLEXKIT® SR Connection kits for FLEXTRACE® SR series heating cables

Description

- OMERIN provides a complete range of **FLEXKIT® SR** connection kits: the **FLEXKIT® SR POWER** power supply kit, the **FLEXKIT® SR JUNCTION** junction kit, and the **FLEXKIT® SR END** termination kit. These kits are designed for use with **FLEXTRACE® SR** series heating cables.
- **FLEXKIT® SR** kits are available in MEDIUM and LARGE size, perfect for the different AWG ratings of **FLEXTRACE® SR** series heating cables.
- **FLEXKIT® SR** kits can be installed at temperatures down to -30°C . We recommend that you store the products in a dry location away from frost and humidity.
- To ensure a high degree of quality and reliability, the **FLEXTRACE® SR** solution is CSA/UL certified: Certificate No. 70181482, Master Contract No.: 177410.

Certifications Approvals



FLEXKIT® SR connection kits

FLEXKIT® SR POWER

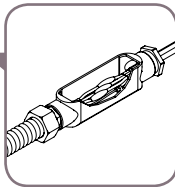

- Connects the power supply cable and the **FLEXTRACE® SR** series heating cable.

The conductor dimensions on the power supply cable are defined according to the installed power. The kit includes a flexible aluminum hose to protect the power supply cable, an aluminum junction box and the accessories required to splice cables, to attach, seal, waterproof and electrically insulate the box. **Continuous exposure temperature up to $+150^{\circ}\text{C}$.**

Available in MEDIUM and LARGE size depending on the AWG rating of the cable used (see selection guide below). For MEDIUM size, 2 references are available depending on the power and maximum intensity of the heat tracing system.

FLEXKIT® SR JUNCTION

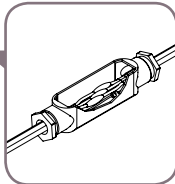

- Connects 2 lengths of **FLEXTRACE® SR** series heating cables.

The kit includes an aluminum junction box and the accessories required to splice cables, to seal, attach, waterproof and electrically insulate the box. **Continuous exposure temperature up to $+150^{\circ}\text{C}$.**

Available in MEDIUM and LARGE size depending on the AWG rating of the cable used (see selection guide below).

FLEXKIT® SR END

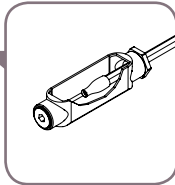

- Allows to terminate the end of the circuit.

The kit includes an aluminum junction box and the accessories required to terminate the cable, to seal, attach, waterproof and electrically insulate the box. **Continuous exposure temperature up to $+150^{\circ}\text{C}$.**

Available in MEDIUM and LARGE size depending on the AWG rating of the cable used (see selection guide below).

FLEXKIT® SR selection guide

FLEXTRACE® SR series heating cables			FLEXKIT® SR connection kits		
1 CONDUCTOR	2 CONDUCTORS	3 CONDUCTORS	POWER SUPPLY	JUNCTION	TERMINATION
SR1 AWG 18	SR2 AWG 18	SR3 AWG 18	SR POWER MEDIUM*	SR JUNCTION MEDIUM	SR END MEDIUM
SR1 AWG 16	SR2 AWG 16	SR3 AWG 16	With AWG 12 power cable (Max permissible current 20A) P/N: ZQ50112001	With AWG 8 power cable (Max permissible current 40A) P/N: ZQ50112002	P/N: ZQ50112003
SR1 AWG 14	SR2 AWG 14	SR3 AWG 14			
SR1 AWG 12	SR2 AWG 12	SR3 AWG 12			
SR1 AWG 10	SR2 AWG 10	SR3 AWG 10			
SR1 AWG 8	SR2 AWG 8	SR3 AWG 8	SR POWER LARGE	SR JUNCTION LARGE	SR END LARGE
			With AWG 8 power cable (Max permissible current 40A) P/N: ZQ50112004	P/N: ZQ50112005	P/N: ZQ50112006



www.omerin.com

EMEA & ASIA

FLEXELEC SAS
10 rue des frères Lumière
69720 Saint-Bonnet de Mure
FRANCE

Phone: +33 (0)4 72 48 30 90
flextracesr@omerin.com

AMERICAS

OMERIN USA, Inc. QS Technologies division
95 Research Parkway
Meriden, Connecticut 06450
USA

Phone: +1 203-237-2297
flextracesr@omerin.com

DIAGRAM	COMPONENT DESCRIPTION	POWER MEDIUM P/N: ZQ50112001	POWER MEDIUM P/N: ZQ50112007	POWER LARGE	JUNCTION MEDIUM	JUNCTION LARGE	END MEDIUM	END LARGE
A	DN18 flexible aluminum hose diameter 18 mm Length 1 m / Supplied with 2 straight male 3/4" unions	✓	✓	-	-	-	-	-
	DN23 flexible aluminum hose diameter 23 mm Length 1 m / Supplied with 2 straight male 1" unions	-	-	✓	-	-	-	-
B	Aluminum junction box size M with 2 inputs Supplied with cover, seal and 2 screws	✓	✓	-	✓	-	-	-
	Aluminum junction box size L with 2 inputs Supplied with cover, seal and 2 screws	-	-	✓	-	✓	-	-
C	Aluminum junction box size M with 1 input Supplied with cover, seal and 2 screws	-	-	-	-	-	✓	-
	Aluminum junction box size L with 1 input Supplied with cover, seal and 2 screws	-	-	-	-	-	-	✓
D	Stainless steel cable gland size M	✓	✓	-	✓	-	✓	-
	Stainless steel cable gland size L	-	-	✓	-	✓	-	✓
E	Silicone elastomer seal size M	✓	✓	-	✓	-	✓	-
	Silicone elastomer seal size L	-	-	✓	-	✓	-	✓
F	Heat shrink sleeve	✓	✓	✓	✓	✓	✓	✓
G	Clamp tube	✓	✓	✓	✓	✓	✓	✓
H	Serrated clamp collar diameter 50 mm to 370 mm	✓	✓	✓	✓	✓	✓	✓
I	Tube of cold-cure silicone paste	✓	✓	✓	✓	✓	✓	✓
J	ELECTRICAL HEAT TRACING warning label	✓	✓	✓	✓	✓	✓	✓
K	FLEXKIT® SR Installation manual	✓	✓	✓	✓	✓	✓	✓
L	AWG 8 Power supply cable - Length 1,50 m	✓	✓	✓	✓	✓	✓	✓
	AWG 12 Power supply cable - Length 1,50 m	-	-	-	-	-	-	-

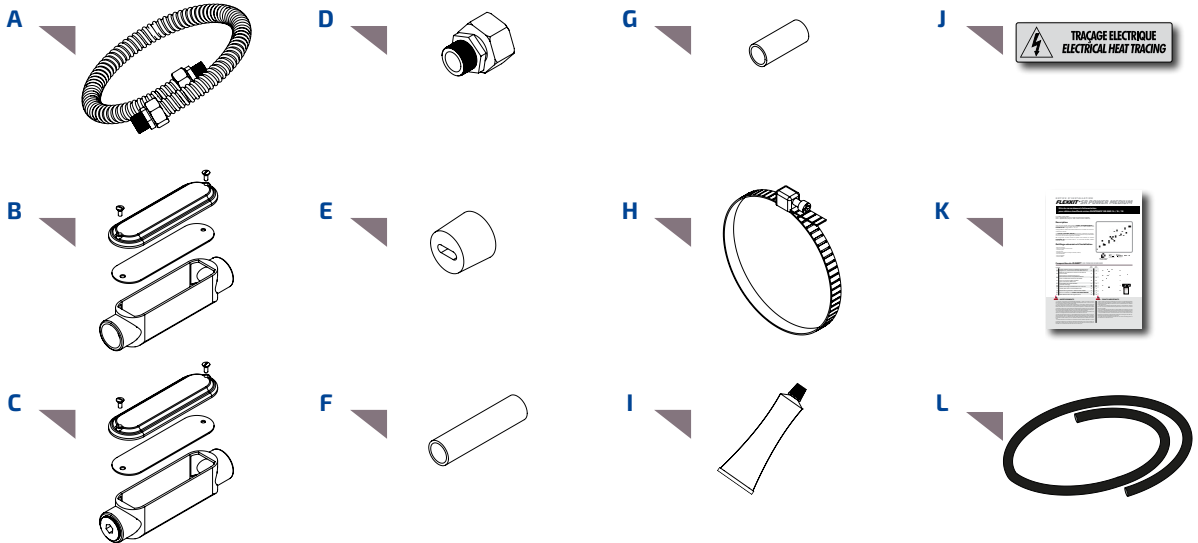

Installation instructions:

• **FLEXKIT® SR** connection kits are delivered with their individual installation manuals, which are to be strictly respected. OMERIN declines all liability in case of non-observance of the installation instructions provided. Also, an installation manual for the whole **FLEXTRACE® SR** system shall be provided for implementation of the **FLEXTRACE® SR** electrical tracing solution.

Warnings:

• Only use components supplied or specified by OMERIN. For safety reasons, never replace **FLEXKIT® SR** components with product not sold or specified by OMERIN.